

MASTER TREE PLAN



CAPE CHARLES, VA

2006

Table of Contents

Introduction – Intent and Purpose Statement	3
Identification of “Signature Trees”	3
Requirements for Landscaping and Screening in Cape Charles Streetscapes ...	3
Definition of Streetscape	3
Existing Developed Areas	5
Historic District	6
Large Lot/Undeveloped Areas	6
Landscaping Requirements for Streetscapes	8
Landscaping and Screening Regulations	8
Removal and Replacement of Existing Trees	9
Listing of appropriate trees by type and location for Streetscape	10
Tree Maintenance Requirements and Pruning Recommendations	16
Implementation Strategy	16
Tree Inventory	17
Plan for Future Funding	17
Planting Plan	17
Appendix A – 2006 Tree Inventory	18



Sweet Gum



Camellia



Linden



**Japanese Red
Maple**

Introduction – Intent and Purpose Statement

The intent of the Tree Master Plan is to develop vibrant green infrastructure in all town districts by promoting the planting of appropriate new trees, and protecting appropriate existing trees. The Plan's purpose is to ensure the beauty and ecological health of Cape Charles for its citizens and guests.

Identification of "Signature Trees" and the significance of those varieties: historically, functionally, and aesthetically in Cape Charles

The historic fabric of Cape Charles includes its signature plantings – types of trees notable for size, age and rarity, as well as those traditionally planted by residents for food or shade. Among these signature trees and plantings are Crape Myrtle, Sycamore, Pecan, Sweet Gum, Carolina Cottonwood, Linden, Basswood, Japanese Black Pine, Fig, Camellia, and Nandina.

Signature trees are important community assets. They enhance the beauty of Cape Charles for its residents and guests. They protect property values and help draw tourists. Signature trees should be preserved when possible or replaced when removed. Landscaping plans for new construction in all districts should include appropriate signature trees and bushes.

Requirements for Landscaping and Screening in Cape Charles Streetscapes

Definition of Streetscape (including excerpts as described in the Cape Charles Preservation Plan)

Streetscape includes all public rights-of-way, all front yards to the plane of the front of the house, and on corner lots, all side yards to the plane of the side of the house, as shown in the following diagram (Figure 1).

EXISTING DEVELOPED AREAS
(HISTORIC AND OTHER DEVELOPED AREAS)

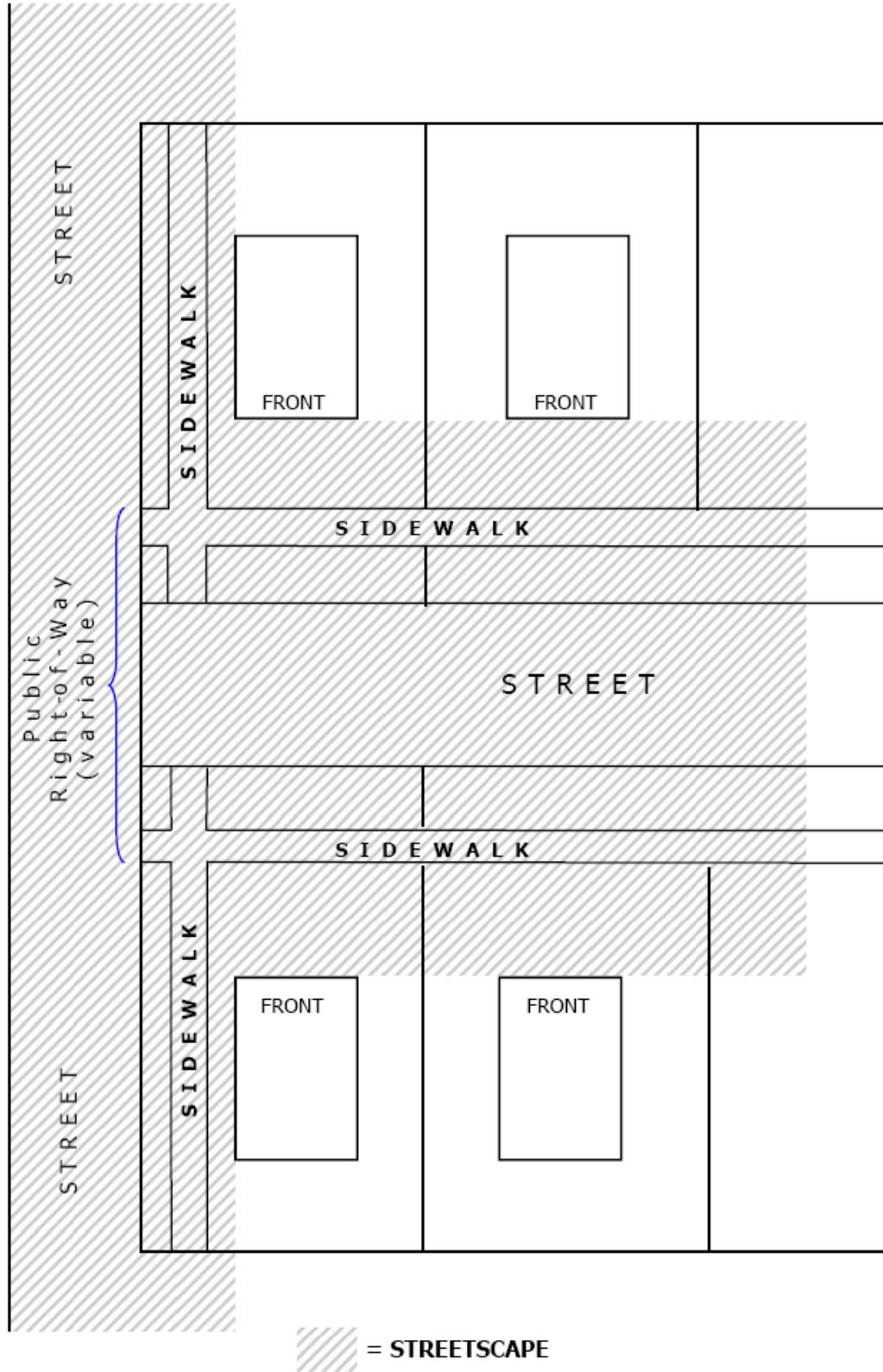

Figure 1

Existing Developed Areas

The character of the streetscape is very important in defining the character of Cape Charles. In many ways, the livability and apparent prosperity of the town is more dependant upon the visual quality of the streetscapes than it is upon the actual condition or appropriate rehabilitation of the town's historic buildings.

In Cape Charles, the streetscapes are comprised of the classic elements of the small-town, American neighborhood – the street, the sidewalk, and the front yard. Neighborhood streets in Cape Charles come in two types: 1) The standard streets with asphalt paving and concrete curbs and 2) Small grass strips divide the sidewalk from the curb. Front yards are generous and lead to open front porches. Street trees, understory trees, occasional wooden or decorative metal fences, and outbuildings are important elements in the landscape.

Areas within the town boundaries that are excluded as defined by the Cape Charles local Historic District Overlay Map shall be considered existing developed areas as defined above. Development of these areas shall include planting or the replacement of trees for the site. The goal is to have a minimum of one (1) tree per twenty (20') feet of lot frontage, to the extent at 20 years, minimum tree canopies or covers will provide a 20% tree canopy for sites zoned residential. Existing trees which are to be preserved may be included to be all or in part of the canopy requirements if the approved site plan identifies such trees, and the trees meet the standards of appropriateness and the life-year expectancy of at least 20 years at which time the canopy requirements are met. (VAC § 15.2 – 961)

Historic District

In addition to the standard neighborhood street, Cape Charles has the central boulevards, Peach Street and Monroe Avenue. These streets were originally paved with concrete and had central landscaped island dividers. Along Peach Street, only one and one-half blocks of concrete paving and islands remains, the blocks immediately south of the central park. Along other portions of Peach Street the islands have been removed and the entire street has been paved with asphalt paving. The original concrete paving and landscaped islands remain along Monroe Avenue. West Monroe Avenue has a wide landscaped island. East Monroe Avenue has a narrow landscape island with wider grass strips between the curb and the sidewalk.

Large Lot/Undeveloped Areas

There are a number of areas within the town boundaries that are undeveloped, including large lots, with a variety of zoning designations. It is desirable to have trees and plantings placed within the streetscape (setback areas as defined in the Zoning Ordinance, required buffer areas, and maximum lot coverage requirements). Development of these areas will include planting or the replacement of trees for the site, to the extent at 20 years minimum, tree canopies or covers will provide a 10% tree canopy for sites zoned business, commercial or industrial. Existing trees which are to be preserved may be included to be all or in part of the canopy requirements and may include wooded preserves, if the approved site plan identifies such trees, and the trees meet the standards of appropriateness and the life-year expectancy of at least 20 years at which time the canopy requirements are met. (VAC § 15.2 – 961). Large Lot/Undeveloped Areas are described and shown in Figure 2.

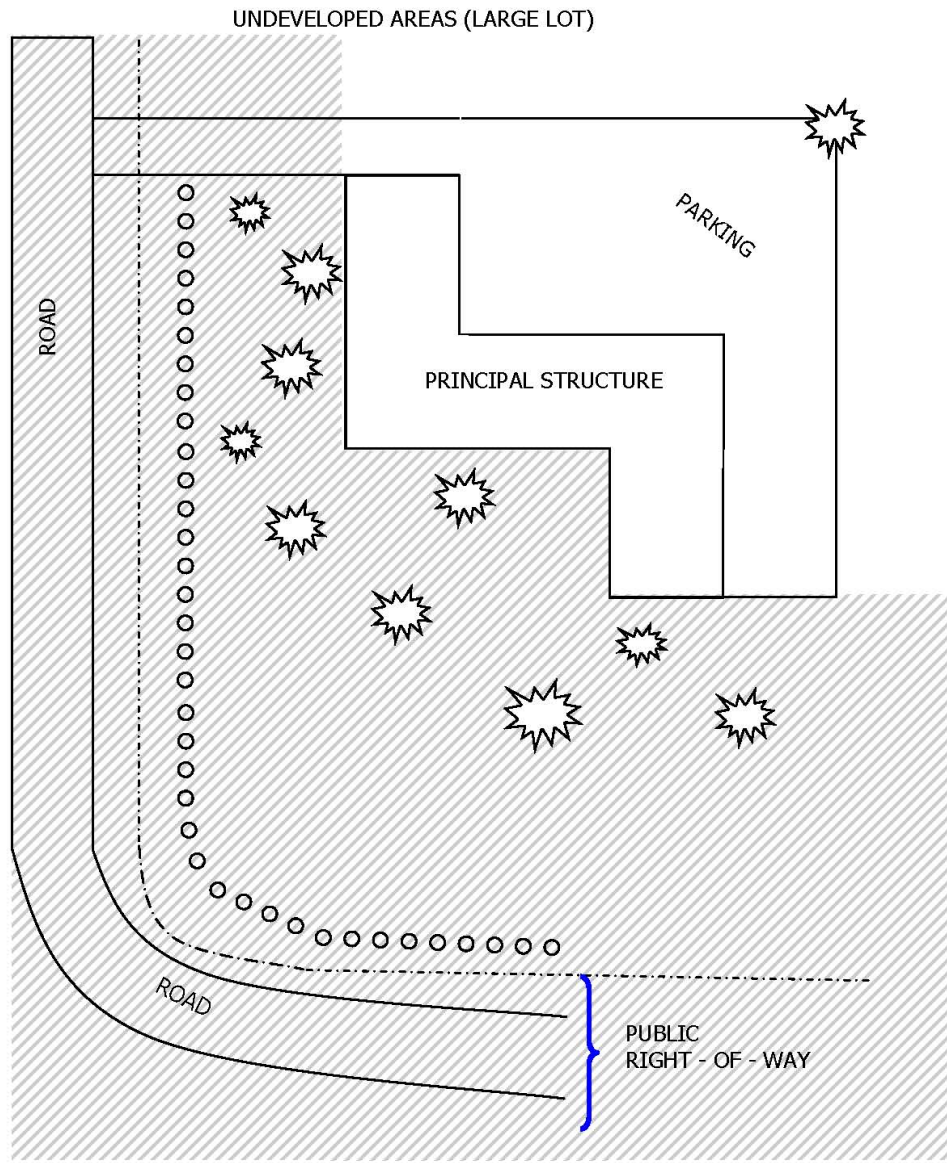



-  = STREETSCAPE
-  = SETBACK (MIN.) AS DESCRIBED IN ZONING ORDINANCE
-  = EXISTING TREES (WHICH MAY BE CREDIT TOWARD THE 10% CANOPY REQUIREMENT)

Figure 2

The single most dramatic action that the town or individual property owners can take to improve significantly the character of Cape Charles is the planting of many new trees and shrubs in yards and along streets. Significant canopy tree planting throughout the town is encouraged. Where overhead wires exist, rows of appropriate trees and shrubs should be planted. Existing trees should be pruned to grow around overhead wires and should never be topped.

Landscaping Requirements for Streetscapes

Landscaping and Screening Regulations

Statement of Intent. The intent of these regulations is: to perpetuate tree growth, to encourage tree preservation, to provide adequate tree canopy and density, to protect water quality by minimizing erosion and sedimentation, enhancing the infiltration of storm water runoff, and maximizing nutrient intake. The intent of these regulations is also to preserve and enhance the aesthetics of the Town, and to reduce the negative impact such as noise and glare of uses and structures which are in close proximity to each other and generally regarded as incompatible, to promote attractive landscaping in residential, commercial and industrial districts of the Town. A comprehensive plan for each individual lot or parcel is essential for the visual enhancement of the Town and to protect and promote appearance, character, and economic values. The purpose and intent of such landscaping requirements are to reduce the visibility of paved areas from adjacent properties and streets, moderate climatic effects, minimize noise and glare, and enhance public safety. Landscaping will provide transition and buffers between neighboring properties.

General Requirements. Landscaping shall be required in all residential, commercial and industrial districts. The owner or his agent shall be responsible for the maintenance, repair, and replacement of all landscaping materials as may be required under Town ordinances.

All plant material, including trees, shall be tended and maintained in a healthy growing condition and free from refuse and debris and invasive species as determined by the Division of

Forestry or the Department of Agriculture, at all times. All unhealthy, dying, or dead plant materials shall be replaced during the next planting season.

Commercial and industrial district uses that abut residential zones shall provide a landscape buffer or screened areas between districts.

All parking lots shall be screened and landscaped from adjoining properties or every other use and zoning district.

Land disturbance shall be limited to the area necessary to provide for the desired use or development.

The Cape Charles Historic District Guidelines referencing Street trees and Plantings are incorporated by reference (Streetscape, pgs. 65-66)

Removal and Replacement of Existing Trees

The goal of this Tree Master Plan is to retain a “no net loss” in terms of trees in the streetscapes throughout the Town. However, the private property rights of landowners shall be respected in order to permit the uses of the property in accordance with the Town’s zoning ordinance. Therefore, removal of trees is allowed within the building envelope. Removal of diseased or unsafe trees is also allowed. Clearing shall be allowed only to provide a building site, necessary access, positive site drainage, water quality BMPs, and the installation of utilities as approved by Town officials. Replacement should be provided as described in General Requirements, paragraph 2.

Listing of appropriate trees by type and location for Streetscape

Appropriate trees are suggested by Virginia Cooperative Extension of Virginia Tech (www.ext.vt.edu/pubs/trees) and shall be used in accordance with the Town's zoning ordinance.

Canopy Trees and Suggested Plantings for Streetscape

Where Overhead Wires Exist

Amur Maple (*Acer ginnala*)
Flowering Apricot (*Prunus mume*)
Flowering Crabapple (*Malus* spp.)
Fringetree (*Chioanthus virginicus*)
Goldenraintree (*Koelreuteria paniculata*)
Japanese Maple (*Acer palmatum*)
Kousa Dogwood (*Cornus kousa*)
Little Gem Magnolia (*Magnolia grandiflora* 'Little Gem')
Okame Cherry (*Prunus* x 'Okame')
Saucer Magnolia (*Magnolia* x *soulangiana*)
Star Magnolia (*Magnolia stellata*)
White Redbud (*Cercis canadensis* 'Texas White')
Yoshino Cherry (*Prunus* x *yedoensis*)

Large Shrubs That Can be Pruned Into Tree Form

Althea/Rose of Sharon (*Hibiscus syriacus*)
Chastetree (*Vitex agnus-castus*)
Crape Myrtle (*Lagerstroemia indica*)

Where Overhead Wires Do Not Exist

American Elm (*Ulmus americana*)

American Sycamore (*Platanus occidentalis*)
Common Hackberry (*Celtis occidentalis*)
Eastern Cottonwood (*Populus deltoides*)
Ginkgo (*Ginkgo biloba* – very slow growing)
Green Ash (*Fraxinus pennsylvanica*)
Honey Locust (*Gleditsia triacanthos*)
Linden (*Tilia* sp.)
Littleleaf Linden (*Tilia cordata*)
Pecan (*Carya illinoensis*)
Pin Oak (*Quercus palustris*)
Red Maple (*Acer rubrum*)
Red Oak (*Quercus rubra*)
River Birch (*Betula nigra*)
Sweetbay Magnolia (*Magnolia virginiana*)
Sweetgum (*Liquidambar styraciflua* – the variety 'rotunda loba' produces no gum balls)
Tulip tree (*Liriodendron tulipifera*)
Water Oak (*Quercus nigra*)
White Oak (*Quercus alba*)
Willow Oak (*Quercus phellos*)

Salt-Tolerant for the Bay/Beachfront Area

Sycamore (*Acer*)
Hackberry (*Celtis laevigata*)
Ginkgo (*Ginkgo biloba* – very slow growing)
Honey locust (*Gleditsia triacanthos*)
American Holly (*Ilex opaca*)
Black Walnut (*Juglans nigra*)

Eastern Red Cedar (*Juniperus virginiana*)

Sweetgum (*Liquidambar styraciflua* – the variety 'rotunda loba' produces no gum balls)

Southern Magnolia (*Magnolia grandiflora* – grass will not grow under it)

Japanese Black Pine (*Pinus thunbergiana*)

Live Oak (*Quercus virginiana*)

(White, Pin, Red, and Willow Oak will also tolerate salt spray drift)

Evergreen Trees for Screening

American Holly (*Ilex opaca* – grass will not grow under it)

Arborvitae (*Thuja* spp. 'Emerald Green')

Dwarf Southern Magnolia ((*Magnolia grandiflora* 'Little Gem')

Eastern Red Cedar (*Juniperus virginiana*)

Eastern White Pine (*Pinus strobes*)

Foster Holly (*Ilex x attenuate*)

Japanese Cryptomeria (*Cryptomeria japonica* - grass will not grow under it)

Leyland Cypress (x *Cupressocyparis leylandii* - large, fast growing, prone to bagworms)

Loblolly Pine (*Pinus taeda*)

Nellie Stevens Holly (*Ilex x 'Nellie R. Stevens'*)

Sweetbay Magnolia (*Magnolia virginiana*)

Virginia Pine (*Pinus virginiana*)

Parking Lots and Paved Areas

Amur Maple (*Acer ginnala*)

Arborvitae (*Thuja occidentalis* 'Emerald Green')

Chastetree (*Vitex agnus-castus*)

Cornelian Cherry (*Cornus mas*)

Crabapple (*Malus baccata*)
Eastern Red Cedar (*Juniperus virginiana*)
Ginkgo (*Ginkgo biloba* – very slow growing)
Goldenraintree (*Koelreuteria paniculata*)
Honey locust (*Gleditsia triacanthos* 'Shademaster')
Japanese Crape Myrtle (*Lagerstroemia fauriei*)
Lacebark Elm (*Ulmus parvifolia*)
Littleleaf Linden (*Tilia cordata*)
Scarlet Oak (*Quercus coccinea* – potentially large)
Southern Magnolia (*Magnolia grandiflora* - grass will not grow under it)
Sweetbay Magnolia (*Magnolia virginiana*)

Virginia's Highly Invasive Species (Never Recommended)

Alligator Weed (*Alternanthera philoxeroides*)
Aneilema (*Murdannia keisak*)
Asiatic sand sedge (*Carex kobomugi*)
Autumn olive (*Elaeagnus umbellata*)
Canada thistle (*Cirsium arvense*)
Chinese lespedeza (*Lespedeza cuneata*)
Chinese privet (*Ligustrum sinense*)
Chinese yam (*Dioscorea oppositifolia*)
Cogon grass (*Imperata cylindrica*)
Common reed (*Phragmites australis*)
European water-milfoil (*Myriophyllum spicatum*)

Garlic Mustard (*Alliaria petiolata*)

Hydrilla (*Hydrilla verticillata*)

Japanese honeysuckle (*Lonicera japonica*)

Japanese knotweed (*Polygonum cuspidatum*)

Japanese stilt grass (*Microstegium vimineum*)

Johnson grass (*Sorghum halepense*)

Kudzu vine (*Pueraria Montana*)

Lesser celandine (*Ranunculus ficaria*)

Mile-a-minute (*Polugonum perfoliatum*)

Morrow's honeysuckle (*Lonicera morowii*)

Multiflora rose (*Rosa multiflora*)

Oriental bittersweet (*Celastrus orbiculata*)

Parrot feather (*Myriophyllum aquaticum*)

Porcelain-berry (*Ampelopsis brevipedunculata*)

Purple loosestrife (*Lythrum salicaria*)

Short fringed knapweed (*Centaurea dubia*)

Spotted knapweed (*Centaurea biebersteinii*)

Standish's honeysuckly (*Lonicera standishii*)

Tree of Heaven (*Ailanthus altissima*)

Wineberry (*Rubus phoenicolasius*)

Winged burning bush (*Euonymus alata*)

Other - Suggested Shrubs for Private Property (not for Public Right-of-Ways)

Camellia

Fig

Knockout Rose

Nandina

Oleander

Trees for Public Rights of Way and Spaces

Canopy Trees

American Sycamore (*Platanus occidentalis*)

Littleleaf Linden (*Tilia cordata*)

Live Oak (*Quercus virginiana*)

London Plane (*Plantanus x acerifolia*)

Pin Oak (*Quercus palustris*)

Red Maple (*Acer rubrum*)

Sweetgum (*Liquidambar styraciflua* 'rotunda loba')

Tulip tree - also known as Yellow Poplar (*Liriodendron tulipifera*)

Willow Oak (*Quercus phellos*)

Overhead Utility Easements

Low Height Zone - Generally less than 20 feet at maturity

Amur Maple (*Acer ginnala*)

Flowering Crabapple (*Malus tschonoskii*)

White Redbud (*Cercis Canadensis* 'Texas White')

Purple Plum (*Prunus avium* 'Pissardii')

Crape Myrtle – shrub pruned as a tree

Mid-height Zone – Near but not under utility lines, 20 – 40 feet at maturity

White Redbud (*Cercis Canadensis* 'Texas White')

Kousa Dogwood (*Cornus kousa*)

Golden Raintree (*Koelreuteria paniculata*)

Flowering Apricot (*Prunus mume*)

Okame Cherry (*Prunus x 'Okame'*)

Yoshino Cherry (*Prunus x yedoensis*)

Thornless Cockspur Hawthorne (*Crataegus crus-galli* var. *Inermis*)

Washington Hawthorne (*Crataegus phaenopyrum*)

Tall Narrow Zone – Near but not under utility lines, 40 – 60 feet at maturity

Red Maple (*Acer rubrum* "Armstrong', 'Bowhall')

Ginkgo (*Ginkgo biloba* 'Fairmont', 'Fastigiata')

Sweetbay Magnolia (*Magnolia virginiana*)

English Oak (*Quercus robur* 'Fastigiata', 'Skyrocket')

Tree Maintenance Requirements and Pruning Recommendations

See guidelines provided by The National Arbor Day Foundation "Urban & Community Forestry – A Practical Guide to Sustainability", James R. Fazio

Implementation Strategy

The key implementation tool to implement this Tree Plan is the development of ordinance language that educates, supports the goals of, and enforces this Plan.

Implementation of this Tree Master Plan will include education and training components. The education of citizens, property owners, and Public Utility personnel, and the training in proper tree care and maintenance are essential to the success of meeting the Tree Master Plan goals.

The education component must include such items as:

- Public Support
- Public Information
 - Newspaper Article
 - Speakers/Arbor Day/"Cape Charles Tree Day"?
 - Horticulturist Robert Bredimus
 - Tree Stewards/Tree Steward Organization – to show private citizens how to plant, prune, etc. or do the work themselves
 - 4-H Club project?
- Brochure
 - Development
 - Distribution
- Training for Public Utility Personnel
 - Cape Charles Public Works
 - VDOT
 - Public Utilities
 - Delmarva Power
 - Verizon

Tree Inventory

Although a tree inventory was performed in the mid-1990s, it is out of date. Therefore, an updated inventory was performed by the Ad Hoc Tree Committee in Spring 2006. The Ad Hoc Tree Committee recognizes the need to have a more thorough inventory system, such as i-Tree developed by the U.S. Forest Service in order to maintain an up-to-date tree inventory to collect and analyze tree information. Appendix A contains the updated inventory of trees existing in Spring 2006

Plan for Future Funding

It is recommended that funding for short- and long-term operational expenses be considered in the Town's Annual Operational Budget. Specifically, funding with the Public Works department for maintenance, plantings, and possibly removal of those trees deemed diseased and unsafe. Further, it is recommended that funding for long-term capital expenses be considered in the Town's Capital Improvement Plan for those items which would require major capital outlays.

Planting Plan

A planting plan shall be developed which analyzes the entire town. It should specifically address blocks without trees, large significant areas such as Bay Avenue as well as other developed and undeveloped areas. Public input should be solicited to create this comprehensive plan.

Appendix A – 2006 Tree Inventory

Street	FSR	Dia	Tree	Com 1
Wash613	F	4	pineLL	
Wash609	F	4	pineLL	
Wash607	F	4	pineLL	
Wash603	F	4	pineLL	
Wash601.2	F	4	pineLL	@hydrant
Wash601.1	F	4	pineLL	
Wash529.2	F	4	pineLL	@Nectarine
Wash529.1	F	4	pineLL	
Wash528	F	14	myrtle	@528 Wash
Wash527.2	F	10	myrtle	@pump house
Wash527.1	F	10	myrtle	@pump house
Wash525.5	F	4	pineLL	@pump house
Wash525.4	F	4	pineLL	@pump house
Wash525.3	F	4	pineLL	@pump house
Wash525.2	F	4	pineLL	@pump house
Wash525.1	F	4	pineLL	@pump house
Wash524.2	F	6	"gum, sweet"	opp 520 Wash
Wash524.1	F	36	maple	opp 520 Wash
Wash521	F	6	"gum, sweet"	5 trunks
Wash520.4	F	4	pineLL	opp 518 Wash
Wash520.3	F	4	pineLL	opp 516 Wash
Wash520.2	F	4	pineLL	opp 514 Wash
Wash520.1	F	4	pineLL	
Wash520	F	12	photina	@pump house
Wash520	F	12	photina	@pump house
Wash520	F	12	Plum (2)	@pump house
Wash518	F	6	mulberry	
Wash517.2	F	4	cedar	
Wash515.2	F	4	pineLL	
Wash515.1	F	6	"gum, sweet"	
Wash513	F	4	pineLL	
Wash512	F	36	"cottonwood, eastern"	poison ivy!
Wash511.2	F	3	cedar	@hydrant
Wash511.1	F	3	cedar	
Wash509.2	F	3	cedar	
Wash509.1	F	36	linden	
Wash507.2	F	4	pineLL	
Wash507.1	F	4	pineLL	
Wash505	F	4	pineLL	
Wash504	F	16	"cherry, black"	@504 Wash
Wash503	F	12	cherry	leaning
Wash501.2	F	4	pineLL	
Wash501.1	F	18	cherry	@pole
Wash419	F	4	pineLL	@Plum St
Wash417	F	4	pineLL	
Wash413.1	F	8	"cherry, black "	dead
Wash411.2	F	10	"cherry, black "	opp 418 Wash
Wash411.1	F	12	hackberry	opp 418 Wash
Wash409	F	14	cherry	
Wash408	F	8	cedar	
Wash407	F	8	hackberry	thick vine
Wash405	F	10	cherry	viney

Street	FSR	Dia	Tree	Com 1
Wash404	F	24	"cherry, black"	@400 Wash
Wash403.5	F	8	cherry	
Wash403.4	F	8	cherry	
Wash403.3	F	8	cherry	
Wash403.2	F	8	cherry	
Wash403.1	F	8	cherry	clump
Wash401.3	F	4	pineLL	@hydrant
Wash401.2	F	4	pineLL	
Wash401.1	F	4	pineLL	@Peach St
Wash314	F	4	pineLL	
Wash312.2	F	4	pineLL	
Wash312.1	F	4	pineLL	
Wash311	F	12	myrtle	@church bldg
Wash310.2	F	4	pineLL	
Wash310.1	F	4	pineLL	
Wash308.2	F	4	pineLL	
Wash308.1	F	4	pineLL	
Wash306.2	F	4	pineLL	
Wash306.1	F	4	pineLL	
Wash304.2	F	4	pineLL	
Wash304.1	F	4	pineLL	
Wash302.2	F	4	pineLL	dead
Wash302.1	F	4	pineLL	@Strawberry
Wash218.1	R	20	pecan	
Wash217.5	F leafy	12	photina	USCG-East
Wash217.4	F leafy	12	photina	USCG-East
Wash217.3	F leafy	12	photina	USCG-East
Wash217.2	F leafy	12	photina	USCG-East
Wash217.1	F leafy	12	photina	USCG-East
Wash216	F	12	pecan	
Wash215.5	F leafy	12	photina	USCG-West
Wash215.4	F leafy	12	photina	USCG-West
Wash215.3	F leafy	12	photina	USCG-West
Wash215.2	F leafy	12	photina	USCG-West
Wash215.1	F leafy	12	photina	USCG-West
Wash214.3	R	14	maple	
Wash214.2	S	16	pecan	
Wash214.1	F	10	pecan	
Wash212.3	R	24	pecan	
Wash212.2	S	16	pecan	
Wash212.1	F	14	pecan	
Wash211.2	F	16	hackberry	blister bark
Wash211.1	F	14	gum	
Wash210.4	R	12	pecan	
Wash210.3	S	14	locust	
Wash210.2	S	12	maple	
Wash210.1	F	16	pecan	
Wash209.4	F	8	hackberry	blister bark
Wash209.3	F	8	hackberry	blister bark
Wash209.2	F	8	hackberry	blister bark
Wash209.1	F	8	hackberry	blister bark
Wash208.3	R	16	pecan	
Wash208.2	S	8	cherry	
Wash208.2	S	12	pecan	
Wash208.1	F	12	pecan	

Street	FSR	Dia	Tree	Com 1
Wash208.1	F	18	pecan	
Wash207.4	S	10	cherry	Seabreeze rear
Wash207.3	S	10	cherry	Seabreeze rear
Wash207.2	S	10	cherry	Seabreeze rear
Wash207.1	S	10	cherry	Seabreeze rear
Wash206	R	18	pecan	@206 Wash
Wash204.5	R	16	cherry	Ivy Threat
Wash204.4	R	16	cherry	Ivy Threat
Wash204.3	R	16	cherry	Ivy Threat
Wash204.2	S	16	pecan	
Wash204.1	F	16	pecan	
Wash203.4	R	18	oak-Pin	@Seabreeze
Wash203.3	S	18	oak-Pin	@Seabreeze
Wash203.2	S	18	oak-Pin	@Seabreeze
Wash203.1	F	18	oak-Pin	@Seabreeze
Wash202.2	S	24	pecan	
Wash202.1	F	12	pecan	
Wash201	F	14	oak-Pin	@Seabreeze
Wash200	F	14	pecan	@Harbor Ave
Tazwell 551	F	60	maple	multi-trunk
Tazwe719.3	F	14	cherry	
Tazwe719.2	S	30	magnolia	office bldg
Tazwe719.1	F	14	cherry	dead
Tazwe717.2	F	12	holly	
Tazwe717.1	F	8	pineSL	lot
Tazwe715.2	F	4	myrtle	@715 Tazwe
Tazwe715.1	F	30	oak	
Tazwe704	F	12	myrtle	@704 Tazwe
Tazwe701.cherry	F	4	cherry	
Tazwe701.14	F	8	cherry	
Tazwe701.13	F	8	cherry	
Tazwe701.12	F	12	cherry	
Tazwe701.11	F	8	willow	
Tazwe701.10	F	8	willow	
Tazwe701.09	F	4	cherry	
Tazwe701.07	F	4	cherry	
Tazwe701.06	R	12	holly	
Tazwe701.05	F	24	sycamore	
Tazwe701.04	F	24	sycamore	
Tazwe701.03	F	6	myrtle	@711 Tazwe
Tazwe701.02	F	12	myrtle	
Tazwe701.01	F	24	myrtle	
Tazwe700.3	F	6	dogwood	
Tazwe700.2	F	3	dogwood	
Tazwe700.1	F	30	fir	
Tazwe653	F	6	myrtle	@Fig
Tazwe649.2	F	24	myrtle	
Tazwe649.1	F	24	myrtle	@649 Tazwe
Tazwe648.2	F	28	oak	
Tazwe648.1	F	30	oak	648.2
Tazwe645.5	F	3	myrtle	
Tazwe645.4	S	6	myrtle	
Tazwe645.3	F	12	myrtle	@645 Taxwe
Tazwe645.2	F	16	oak	
Tazwe645.1	S	24	magnolia	

Street	FSR	Dia	Tree	Com 1
Tazwe638.6	S	10	pineSL	
Tazwe638.5	S	10	pineSL	
Tazwe638.4	S	10	pineSL	
Tazwe638.3	F	10	pineSL	
Tazwe638.2	F	10	pineSL	@638 Tazwe
Tazwe638.1	F	8	pineSL	
Tazwe630.4	S	18	hackberry	by driveway
Tazwe630.3	F	16	myrtle	@630 Tazwe
Tazwe630.1	F	4	maple	
Tazwe629.17	R	36	pecan	
Tazwe629.16	R	14	myrtle	
Tazwe518.3	F	20	oak	
Tazwe518.2	F	6	dogwood	@518 Tazwe
Tazwe518.1	F	8	myrtle	
Tazwe517.3	F	6	myrtle	
Tazwe517.2	F	12	myrtle	
Tazwe517.1	F	12	maple	in lot
Tazwe515.3	F leafy	4	myrtle	
Tazwe515.2	F	16	myrtle	@515 Tazwe
Tazwe515.1	F leafy	4	camellia	
Tazwe511.2	F	16	myrtle	@511 Tazwe
Tazwe511.1	F	16	oak	
Tazwe506.2	F	6	myrtle	@506 Tazwe
Tazwe506.1	F	6	pear	
Tazwe501.2	F	3	oak	@501 Tazwe
Tazwe501.1	F	3	myrtle	
Tazwe500	F	24	oak	@Libaray
Tazwe425	F	24	linden	@Plum
Tazwe419	F	4	myrtle	
Tazwe415.3	F	3	myrtle	
Tazwe415.2	F	3	cherry	@415 Tazwe
Tazwe415.1	F	3	myrtle	
Tazwe413.3	F	3	myrtle	
Tazwe413.2	F	2	plum	@413 Tazwe
Tazwe413.1	F	6	myrtle	
Tazwe412.2	F	6	myrtle	@UM Church
Tazwe412.1	F	36	myrtle	clump
Tazwe409.6	F	3	myrtle	
Tazwe409.5	F	8	willow	
Tazwe409.4	F	3	maple	@409?.Tazwe
Tazwe409.3	F	3	myrtle	
Tazwe409.2	F	3	myrtle	
Tazwe409.1	F	3	maple	
Tazwe403.4	S	14	myrtle	
Tazew630.2	F	4	maple	
Tazew629.15	F	8	myrtle	
Tazew629.14	S	20	cedar	
Tazew629.13	S	6	pear	
Tazew629.12	F	3	myrtle	
Tazew629.11	F	14	myrtle	@629 Tazwe
Tazew629.10	F	8	myrtle	
Tazew629.09	S	36	pear	
Tazew629.08	F	8	myrtle	
Tazew629.07	S	4	pear	
Tazew629.06	F	16	maple	

Street	FSR	Dia	Tree	Com 1
Tazew629.05	F	8	pecan	
Tazew629.04	S	18	cedar	
Tazew629.03	S	20	holly	
Tazew629.02	F	20	oak	
Tazew629.01	F	6	myrtle	playground
Tazew620	F	42	sycamore	@620 Tazwe
Tazew616.2	F	6	myrtle	
Tazew616.1	F	6	myrtle	@616 Tazwe
Tazew614	F	24	myrtle	@614 Tazwe
Tazew612	F	4	dogwood	@612 Tazwe
Tazew611	F	8	oak	bushy
Tazew605.1	F	8	fir	
Tazew601.4	F	10	oak	
Tazew601.3	F	14	fir	
Tazew601.2	F	14	maple	@Epis Church
Tazew601.1	F	2	maple	
Tazew551.2	F	8	maple	@Nectarine
Tazew551.1	F	3	myrtle	@551 Tazwe
Tazew545	F	36	oak	@545 Tazwe
Tazew544.5	F	20	myrtle	@Nectarine
Tazew544.4	F	3	myrtle	
Tazew544.3	F	3	myrtle	
Tazew544.2	F	3	myrtle	
Tazew544.1	F	10	myrtle	
Tazew542.2	F	3	myrtle	
Tazew542.1	F	4	myrtle	@542 Tazwe
Tazew538.2	F	4	myrtle	@538 Tazwe
Tazew538.1	F	4	myrtle	
Tazew534.2	F	8	myrtle	@534 Tazwe
Tazew534.1	F	6	myrtle	
Tazew533	F	36	myrtle	clump
Tazew530.3	F	6	myrtle	ramp step
Tazew530.2	F	6	myrtle	@530 Tazwe
Tazew530.1	F	8	myrtle	
Tazew529.6	S	6	oak	
Tazew529.5	S	18	hackberry	blister bark
Tazew529.4	F	18	myrtle	conc flagpole
Tazew529.3	F	36	myrtle	@529 Tazwe
Tazew529.2	R	8	magnolia	
Tazew529.1	F	6	pear	bushy
Tazew522.9	S	6	cottonwood	
Tazew522.8	F	8	dogwood	
Tazew522.7	F	8	myrtle	
Tazew522.6	F	3	myrtle	@522 Tazwe
Tazew522.5	F	3	myrtle	
Tazew522.4	F	8	pineLL	
Tazew522.3	F	6	pineLL	ivy threat
Tazew522.2	S	20	pineLL	
Tazew522.1	F	14	myrtle	
Tazew517.4	F	30	hackberry	blister bark
Tazew408.2	F	8	myrtle	
Tazew408.1	F	6	myrtle	
Tazew403.3	F	24	linden	@403 Tazew
Tazew403.2	F	8	magnolia	
Tazew403.1	F	3	myrtle	dead

Street	FSR	Dia	Tree	Com 1
Tazew321	F	24	cedar	@Peach
Tazew320.2	F	6	maple	
Tazew320.1	F	8	maple	beside 127 Peach
Tazew318.2	F	4	myrtle	
Tazew318.1	F	3	myrtle	@318 Tazew
Tazew304.3	F	8	dogwood	ivy threat
Tazew304.2	F	6	myrtle	
Tazew304.1	F	14	maple	@304 Tazew
Tazew301	F	16	linden	@Strawberry
Tazew244	F red spot	48	linden	@244 tazew
Tazew242	F	10	oak	@242 tazew
Tazew240.2	F red spot	16	"gum, sweet"	@240 tazew
Tazew240.1	F leafy	6	camellia	
Tazew239.3	F	18	sycamore	
Tazew239.2	R	26	pineLL	ivy threat
Tazew239.1	F	18	sycamore	@231 Tazew
Tazew238	F	6	myrtle	@238 tazew
Tazew235.2	F	32	sycamore	@church
Tazew235.1	F	30	sycamore	@church
Tazew234.2	F	24	pecan	x mark
Tazew234.1	F leafy	8	camellia	@234 Tazew
Tazew230	F	30	linden	@230 Tazew
Tazew229	F red spot	42	linden	@229 Tazew
Tazew226.2	F	14	cedar	
Tazew226.1	F	14	cedar	@226 Tazew
Tazew223	F	4	dogwood	@223 Tazew
Tazew222.2	F	3	myrtle	
Tazew222.1	F	3	myrtle	@222 Tazew
Tazew221.2	F	2	myrtle	
Tazew221.1	F	4	myrtle	@221 Tazew
Tazew219.4	F	10	pear	
Tazew219.3	F	10	"elm, american"	@219 Tazew
Tazew219.2	F	3	myrtle	
Tazew219.1	F	6	myrtle	
Tazew218.2	F	3	myrtle	
Tazew218.1	F	3	myrtle	@218 Tazew
Tazew215.3	R	24	maple	
Tazew215.2	F	8	myrtle	
Tazew215.1	F	4	myrtle	@215 Tazew
Tazew211	F	8	myrtle	@211 Tazew
Tazew210.2	R	14	pineLL	
Tazew210.1	F	14	pineLL	@210 Tazew
Tazew209.3	R	14	magnolia	
Tazew209.2	F	6	myrtle	
Tazew209.1	F	6	plum	@209 Tazew
Tazew207.3	F	6	dogwood	@207 Tazew
Tazew207.2	F	24	plum	warts on bark
Tazew207.1	F	20	linden	
Tazew206.5	F	6	myrtle	
Tazew206.4	F	8	myrtle	
Tazew206.3	F	6	magnolia	@206 Tazew
Tazew206.2	F	3	myrtle	
Tazew206.1	F	8	myrtle	
Tazew206..6	F	6	magnolia	
Tazew116.2	F	4	myrtle	@Pine

Street	FSR	Dia	Tree	Com 1
Tazew116.1	F	6	myrtle	@116 Tazew
Tazew114.2	F	8	myrtle	
Tazew114.1	F	20	maple	@114 Tazew
Tazew113.2	F	4	holly	
Tazew113.1	F	3	holly	@113 Tazew
Tazew111	F	20	myrtle	@111 Tazew
Tazew110.3	S	20	myrtle	
Tazew110.2	F	16	linden	@110 Tazew
Tazew110.1	F	2	oak	
Tazew109	F	6	plum	@109 Tazew
Tazew106.3	F	14	myrtle	@106 Tazew
Tazew106.2	F	8	myrtle	
Tazew106.1	F	3	myrtle	
Tazew105	F	30	linden	@105 Tazew
Tazew102.2	F	22	maple	@102 Tazew
Tazew102.1	F	8	magnolia	
Tazew101.5	F	6	oak-Red	
Tazew101.4	F	10	myrtle	
Tazew101.3	F	6	myrtle	
Tazew101.2	F	3	myrtle	
Tazew101.1	F	3	maple	
Tazew010.6	F	4	fir	@Harbor
Tazew010.5	F	4	fir	
Tazew010.4	F	4	myrtle	
Tazew010.3	F	14	myrtle	
Tazew010.2	F	8	myrtle	@10 Tazew
Tazew010.1	F	3	myrtle	
Tazew009.6	F	6	myrtle	@Harbor
Tazew009.5	F	36	linden	red spot paint
Tazew009.4	F	12	myrtle	
Tazew009.3	F	12	myrtle	@9 Tazew
Tazew009.2	F	4	myrtle	
Tazew009.1	F	12	myrtle	
Tazew006.6	R	36	pecan	
Tazew006.5	F	3	myrtle	
Tazew006.4	F	12	magnolia	tulip
Tazew006.3	F	40	maple	@6 Tazew
Tazew006.2	F	12	myrtle	
Tazew006.1	F	14	myrtle	
Tazew005.7	S	6	pineLL	
Tazew005.6	S	3	cherry	
Tazew005.5	F	10	myrtle	
Tazew005.4	F	10	myrtle	
Tazew005.3	F	14	myrtle	@5 Tazew
Tazew005.2	F	24	myrtle	clump
Tazew004.4	F	8	myrtle	
Tazew004.3	F	12	myrtle	@4 Tazew
Tazew004.2	F	12	myrtle	
Tazew004.1	F	14	myrtle	
Tazew003.6	F	4	myrtle	clump
Tazew003.5	F	2	maple	@3 Tazew
Tazew003.4	F	3	birch	
Tazew003.3	F	6	myrtle	
Tazew003.2	F	20	maple	
Tazew003.1	S	12	pineLL	

Street	FSR	Dia	Tree	Com 1
Tazew001.4	F	8	myrtle	
Tazew001.3	F	8	myrtle	
Tazew001.2	F	24	maple	clump
Tazew001.1	F	12	myrtle	clump
Taze318	F	8	pears	two
Taze242	F	6	"maple, ashley"	
Taze225	F	12	sassafras	
Straw617	F	26	maple	@Washington
Straw615	F	14	fir	@615 Straw
Straw604	F	12	chinaberry	berries
Straw602	F	12	myrtle	@Barber Shop
Straw512.2	F	8	myrtle	@512?.Straw
Straw512.1	F	12	myrtle	
Straw510.2	F	40	"cherry, black"	@pole 53430
Straw510.1	F	20	hackberry	blister bark
Straw509	F	10	pineSL	
Straw309.2	F	18	maple	
Straw309.1	S	20	cedar	ivy threat
Straw305.7	S	8	fir	
Straw305.6	S	6	fir	
Straw305.5	S	8	fir	
Straw305.4	S	6	fir	
Straw305.3	S	6	fir	
Straw305.2	F	8	fir	
Straw305.1	F	4	myrtle	@305 Straw
Straw303	F	4	myrtle	@303 Straw
Straw301	F	36	elm	@Alley
Straw300.5	F	12	pineLL	@Madison
Straw300.4	F	8	myrtle	
Straw300.3	F	6	myrtle	
Straw300.2	F	4	myrtle	
Straw300.1	F	20	linden	@Park Row
Straw218.7	F	3	oak	opp Monroe
Straw218.6	F	3	oak	in Park
Straw218.5	F	3	oak	in Park
Straw218.4	F	3	oak	in Park
Straw218.3	F	3	oak	in Park
Straw218.2	F	3	oak	in Park
Straw218.1	F	3	oak	in Park
Straw217.2	F	4	myrtle	@Monroe
Straw217.1	F	30	linden	opp Park
Straw215	F	30	linden	opp Park
Straw213	F	35	linden	side of church
Straw212	F	20	linden	@212 Straw
Straw204	F	24	linden	lot
Straw121.3	F	6	myrtle	
Straw121.2	F	3	maple	@121?.Straw
Straw121.1	F	3	myrtle	
Straw117.4	F	4	myrtle	@117 Straw
Straw117.3	F	3	maple	
Straw117.2	F	3	myrtle	
Straw117.1	F	3	myrtle	
Straw101.2	F	24	pine-Scrub	@USPO
Straw101.1	F	14	pine-Scrub	@USPO
Straw012	F	14	linden	@Tazewell

Street	FSR	Dia	Tree	Com 1
Straw001.1	F	6	myrtle	
Straw000.1	F	12	myrtle	@Mason
Randol654	F	20	pineSL	
Randol645.3	F	12	myrtle	@Fig
Randol645.2	F	10	myrtle	
Randol645.1	F	10	myrtle	@645 Randol
Randol641	F	20	myrtle	@641 Randol
Randol637	F	12	myrtle	@637 Randol
Randol633.2	F	8	myrtle	
Randol633.1	F	12	myrtle	@633 Randol
Randol622	F	8	myrtle	@622 Randol
Randol618	F	8	myrtle	@618 Randol
Randol614.2	F	20	myrtle	@614 Randol
Randol614.1	F	24	myrtle	
Randol610.1	F	12	myrtle	
Randol606.3	F	16	oak	@606 Randol
Randol606.2	F	6	myrtle	
Randol606.1	F	12	myrtle	
Randol602	F	14	myrtle	@Nectarine
Randol601.2	F	8	myrtle	@610 Randol
Randol547	F	28	oak	@Cath Church
Randol546.2	F	6	myrtle	@546 Randol
Randol546.1	F	3	myrtle	
Randol545	F	3	"crabapple, dead"	@545 Randol
Randol544.3	F	3	myrtle	
Randol544.2	F	3	myrtle	@544 Randol
Randol544.1	F	3	myrtle	
Randol543	F	14	pineSL	@543 Randol
Randol540.2	F	6	myrtle	
Randol540.1	F	8	myrtle	@540 Randol
Randol527.2	F	8	myrtle	@527 Randol
Randol527.1	F	6	myrtle	
Randol509.1	F	24	myrtle	@509 Randol
Randol506.1	F	36	maple	@506 Randol
Randol424	F	8	linden	@424 Randol
Randol416	F berry	4	magnolia	@416 Randol
Randol415.2	F	4	myrtle	@415 Randol
Randol415.1	F	4	myrtle	
Randol408.2	F	3	myrtle	@408 Randol
Randol408.1	F	3	myrtle	
Randol407	F	28	linden	@407 Randol
Randol406.2	F	3	myrtle	
Randol406.1	F	3	myrtle	@406 Randol
Randol340	F	14	maple	@340 Randol
Randol339.4	F	12	myrtle	
Randol339.3	F	12	myrtle	@339 Randol
Randol339.2	S	6	magnolia	
Randol339.1	F	6	myrtle	
Randol332.3	F	4	myrtle	
Randol332.2	F	8	maple	@332 Rasndol
Randol332.1	F	6	myrtle	
Randol328	F	18	maple	@328 Randol
Randol327	F	30	linden	@327 Randol
Randol322	F	8	myrtle	lot
Randol317.2	F	8	myrtle & pecan	blister bark

Street	FSR	Dia	Tree	Com 1
Randol317.1	F	20	linden	
Randol316	F	12	myrtle	@316 Randol
Randol311	F	16	myrtle	
Randol309	F	6	myrtle	@309 Randol
Randol301.2	F	6	myrtle	
Randol301.1	F	30	linden	
Randol244.6	F	12	myrtle	@Strawberry
Randol244.5	F	12	myrtle	lot
Randol244.4	F	12	myrtle	lot
Randol244.3	F	8	myrtle	lot
Randol244.2	F	14	myrtle	lot
Randol244.1	F	42	mulberry	lot
Randol240	F	6	myrtle	@240 Randol
Randol237.9	R	36	myrtle	Blue Evans hse
Randol237.8	S	30	maple	
Randol237.7	F	18	hackberry	Blue Evans hse
Randol237.6	F	24	myrtle	clump
Randol237.5	F	8	myrtle	
Randol237.4	F	36	mulberry	
Randol237.3	F	20	mulberry	@237?.Randol
Randol237.1	F	30	mulberry	
Randol237.1	R	40	mulberry	
Randol236.2	F	14	myrtle	
Randol236.1	F	30	linden	
Randol234.2	F	8	myrtle	
Randol234.1	F	14	myrtle	@234 Randol
Randol231.2	F	6	myrtle	
Randol231.1	F	36	linden	@231 Randol
Randol230.2	F	2	maple	
Randol230.1	F	10	myrtle	@230 Randol
Randol227	F	36	linden	@227?.Randol
Randol226	F	12	myrtle	@226 Randol
Randol221.2	F	4	plum	
Randol221.1	F	6	plum	@222 Randol
Randol218.2	F	12	myrtle	@218 Randol
Randol218.1	F	3	myrtle	
Randol217.2	F	12	myrtle	
Randol217.1	F	10	myrtle	@217 Randol
Randol215.2	F	6	myrtle	
Randol215.1	F	6	myrtle	@215 Randol
Randol214.2	F	3	myrtle	
Randol214.1	F	3	myrtle	@214 Randol
Randol212.2	F	36	myrtle	clump
Randol212.1	F	12	myrtle	@212 Randol
Randol209.2	F	3	myrtle	
Randol209.1	F	3	myrtle	@209 Randol
Randol117	F	20	myrtle	@Pine
Randol115.2	F	3	cherry	
Randol115.1	F berry	22	chinaberry	@115 Randol
Randol112.3	S	18	oak	
Randol112.2	F	12	oak	
Randol112.1	F	6	pineSL	@112 Randol
Randol109	F	6	magnolia	@109 Randol
Randol106.2	F	14	pecan	@106 Randol
Randol106.1	F	12	pecan	

Street	FSR	Dia	Tree	Com 1
Randol105.09	F	14	pecan	
Randol105.08	F	10	pecan	
Randol105.07	F	12	pecan	@105 Randol
Randol105.06	F	14	pecan	
Randol105.05	S	20	myrtle	
Randol105.04	R	14	magnolia	
Randol105.03	F	3	pecan	
Randol105.02	F	12	pecan	
Randol105.01	F	14	pecan	
Randol10	S	4	cedar	
Randol011.4	F	16	maple	@Harbor
Randol011.3	F	4	magnolia	@11 Randol
Randol011.1	F	16	maple	
Randol011.1	F	12	myrtle	
Randol009.9	F	12	oak	
Randol009.8	F	14	myrtle	
Randol009.7	F	20	myrtle	@9 Randol
Randol009.6	F	30	maple	
Randol009.5	R	10	myrtle	
Randol009.4	S	8	fir	
Randol009.3	S	14	myrtle	
Randol009.2	F	8	myrtle	
Randol009.1	F	10	myrtle	
Randol008.5	S	10	myrtle	
Randol008.4	S	14	myrtle	@8?.Randol
Randol008.2	F	10	myrtle	
Randol008.2	S	12	pineLL	
Randol008.1	S	12	pineLL	
Randol006.3	F	6	myrtle	
Randol006.2	F	14	myrtle	
Randol006.1	F	14	myrtle	@6 Randol
Randol005.3	F	20	myrtle	
Randol005.2	F	3	dogwood	@5 Randol
Randol005.1	F	10	myrtle	
Randol004.5	F	14	myrtle	@4 Randol
Randol004.4	F	6	myrtle	
Randol004.3	S	12	myrtle	
Randol004.2	S	12	myrtle	
Randol004.1	F	12	myrtle	
Randol003.13	S	14	myrtle	alley
Randol003.12	S	8	myrtle	alley
Randol003.11	S	12	myrtle	alley
Randol003.10	S	12	myrtle	alley
Randol003.09	S	10	myrtle	alley
Randol003.08	F	10	myrtle	
Randol003.07	R	20	pineLL	
Randol003.06	S	8	pineLL	
Randol003.05	S	8	pineLL	
Randol003.04	S	8	pineLL	
Randol003.03	F	8	oak	
Randol003.02	F	6	myrtle	
Randol003.01	F	4	myrtle	@3 Randol
Randol002.3	F berry	6	pear	
Randol002.2	F	16	myrtle	@2 Randol
Randol002.1	F	8	myrtle	

Street	FSR	Dia	Tree	Com 1
Randol001.8	S	10	pineSL	
Randol001.7	F	10	pineSL	
Randol001.6	F	16	myrtle	
Randol001.5	F	12	myrtle	
Randol001.4	F	12	myrtle	@1 Randol
Randol001.3	F	12	myrtle	
Randol001.2	F	20	myrtle	clump
Randol001.1	F	12	pear	re-growth
Rand509.1	F	8	gardenia	
Rand408		6	magnolia	
Rand406	F	4	dogwood	
Rand404	F	4	redbud	
Plum634	F berry	14	hackberry	@Jefferson
Plum622.2	F	14	hackberry	narly bark
Plum622.1	F leafy	8	hackberry	
Plum618	F	8	cedar	@618 Peach
Plum613	F	10	myrtle	
Plum611	F	24	maple	
Plum607.2	F	14	hackberry	narly bark
Plum607.1	F	12	chinaberry	narly bark
Plum524	F	16	myrtle	@524 Peach
Plum502	F	30	maple	@502 Plum
Plum428	F	24	maple	@428 Madison
Plum416	F	16	maple	@416 Plum
Plum403.2	F	12	cherry	
Plum403.1	F	8	cherry	
Plum402.5	F	12	maple	@Alley
Plum402.4	F	14	myrtle	@Pole 53391
Plum402.3	F	14	pineLL	
Plum402.2	F	4	maple	
Plum402.1	F	20	sycamore	
Plum306.3	F	3	maple	@Monroe
Plum306.2	F	24	oak-red	
Plum306.1	F	26	oak-red	
Plum305.2	F	32	"elm, american"	@Park
Plum305.1	F	36	"elm, american"	@Park
Plum304	F	3	maple	
Plum303	F leafy	2	ligustrum	
Plum302.5	F	12	myrtle	pole
Plum302.4	F	12	myrtle	
Plum302.3	F	12	myrtle	
Plum302.2	F	12	myrtle	
Plum302.1	F	14	myrtle	
Plum301	F	6	myrtle	
Plum105.3	F	3	myrtle	@UM Church
Plum105.2	F	3	myrtle	@UM Church
Plum105.1	F	8	myrtle	
Plum104.2	F	8	myrtle	@Tazewell
Plum104.1	F	6	myrtle	@Library
Plum103	F	36	maple	
Plum102	F	12	myrtle	@Bap Church
Plum101	F	24	maple	
Plum010.2	F	12	myrtle	@ 010 Randolph
Plum010.1	F	10	myrtle	
Plum002.3	F	3	myrtle	

Street	FSR	Dia	Tree	Com 1
Plum002.2	F	3	myrtle	
Plum002.1	F	3	myrtle	@002 Plum
Plum001.3	F	10	myrtle	
Plum001.2	F	8	myrtle	
Plum001.1	F	14	myrtle	@Mason
Plum000.7	F	18	maple	@007 Plum
Pine601.2	F	2	myrtle	clump 3
Pine601.1	F	2	myrtle	clump 3
Pine509	F	6	pear	@Jefferson
Pine507.4	F	12	myrtle	
Pine507.3	F	6	myrtle	
Pine507.2	R	30	myrtle	clump
Pine507.1	F	24	maple	
Pine502.5	F	20	linden	
Pine502.4	F	30	myrtle	clump
Pine502.3	F	6	myrtle	
Pine502.2	F	6	myrtle	
Pine502.1	F	8	myrtle	
Pine501.3	F	8	myrtle	
Pine501.2	F	16	myrtle	
Pine501.1	F	24	linden	
Pine410	F	8	myrtle	@Madison
Pine407.5	F	10	magnolia	@Madison
Pine407.4	F	8	ligustrum	bush
Pine407.3	F	12	pecan	
Pine407.2	F	14	pecan	
Pine407.1	F	6	cedar	
Pine401.3	F	24	pecan	
Pine401.2	F	14	pecan	
Pine401.1	F	14	pecan	
Pine400.4	F	12	dogwood	
Pine400.3	F	6	myrtle	
Pine400.2	F	6	myrtle	
Pine400.1	F	8	myrtle	side of 201 Monro
Pine210.3	F	24	linden	@Monro
Pine210.2	F	12	hackberry+myrtle	clump @pumphse
Pine210.1	F	16	mulberry+hackberry	clump @pumphse
Pine209.2	F	12	myrtle	@Monro
Pine209.1	F	12	pineLL	
Pine208	F	8	myrtle	
Pine207	F	24	myrtle	
Pine201	F	12	maple	
Pine110.4	F	10	myrtle	@Tazewell
Pine110.3	F	4	myrtle	
Pine110.2	F	10	myrtle	
Pine110.1	F	30	linden	
Pine109	F	24	oak	
Pine104.4	F	4	myrtle	
Pine104.3	F	4	myrtle	
Pine104.2	F	10	myrtle	
Pine104.1	F	12	myrtle	@118 Pine
Pine103	F	40	oak	
Pine102.3	F	14	pineLL	ivy threat
Pine102.2	F	14	pineLL	pole
Pine102.1	F	16	pineLL	@116 Pine

Street	FSR	Dia	Tree	Com 1
Pine100	F	12	myrtle	
Pine012	F	16	hackberry	
Pine007.4	F	12	maple	
Pine007.3	F	18	maple	
Pine007.2	F	8	maple	
Pine007.1	F	18	oak	
Pine002.4	F	20	sycamore	@Bank of Am
Pine002.3	F	18	sycamore	@Bank of Am
Pine002.2	F	16	sycamore	@Bank of Am
Pine002.1	F	16	sycamore	@Bank of Am
Pine001.4	F	4	myrtle	
Pine001.3	F	3	myrtle	
Pine001.2	F	2	myrtle	clump
Pine001.1	F	2	myrtle	clump
Peach618	F	8	cedar	
Peach617	F	8	myrtle	lot
Peach609	F	10	hackberry	blister bark
Peach524	F	12	myrtle	
Peach210	F	30	myrtle	Peach Deadend
Peach208	M	10	myrtle	
Peach207.2	F	18	myrtle	
Peach207.1	F	10	myrtle	
Peach205.9	M	6	myrtle	
Peach205.8	M	6	myrtle	
Peach205.7	M	6	myrtle	
Peach205.6	M	6	myrtle	
Peach205.5	M	6	myrtle	
Peach205.4	M	6	myrtle	
Peach205.3	M	8	myrtle	
Peach205.2	M	12	myrtle	
Peach205.1	F	24	cedar	@205 Peach
Peach202	F	8	fir	@403 Tazewell
Peach128.3	M	8	myrtle	
Peach128.2	M	8	myrtle	
Peach128.1	F	3	myrtle	@128 Peach
Peach127	F	12	myrtle	@127 Peach
Peach124.3	F	6	myrtle	
Peach124.2	F	4	oak-Red	
Peach124.1	F	4	oak-Red	@124 Peach
Peach122.3	F	12	myrtle	
Peach122.2	M	12	myrtle	
Peach122.1	F	24	maple	@122 Peach
Peach118.2	F	4	myrtle	
Peach118.1	F	4	myrtle	@118 Peach
Peach117.2	M	8	myrtle	
Peach117.1	F	30	maple	@117 Plum
Peach114	F	10	maple	@114 Plum
Peach113	M	8	myrtle	
Peach102	F	24	oak-Red	@102?.Peach
Peach101.9	M	6	myrtle	
Peach101.8	M	12	myrtle	clump
Peach101.7	M	8	myrtle	
Peach101.6	M	8	myrtle	
Peach101.5	M	8	myrtle	
Peach101.4	F	6	maple	

Street	FSR	Dia	Tree	Com 1
Peach101.3	F	2	myrtle	
Peach101.2	F	3	myrtle	
Peach101.1	F	4	myrtle	clump
Peach011.3	F	16	maple	@Randolph
Peach011.2	F	4	maple	
Peach011.1	F	12	maple	
Street	FSR	Dia	Tree	Com 1
Nect610	F berry	14	hackberry	@610 Nect
Nect606	F	18	myrtle	
Nect602.3	F	3	myrtle	
Nect602.2	F	3	dogwood	
Nect602.1	F	3	myrtle	
Nect601.6	F	4	myrtle	along 539 Taze
Nect601.5	F	4	myrtle	along 539 Taze
Nect601.4	F	4	myrtle	along 539 Taze
Nect601.3	F	4	myrtle	along 539 Taze
Nect601.2	F	4	myrtle	along 539 Taze
Nect601.1	F	4	myrtle	along 539 Taze
Nect511.4	F	18	pineLL	@Jefferson
Nect511.3	F	30	pine-scrub	
Nect511.2	F	18	pineLL	
Nect511.1	F	12	pecan	
Nect509	F	10	pine-scrub	@509 Nect
Nect508	F	24	gum	@508 Nect
Nect507	F	8	myrtle	"church, rear"
Nect506	F	24	gum	@506 Nect
Nect504	F	18	gum	@504 Nect
Nect413	F	14	maple	@Madison
Nect412	F	12	gum	
Nect411	F	24	maple	
Nect410	F	4	myrtle	
Nect409	F	8	myrtle	new house
Nect408.2	F	6	myrtle	@409 Nect
Nect408.1	F	28	maple	@409 Nect
Nect403	F	36	maple	
Nect402	F	6	cherry	
Nect317	F	24	maple	@Monroe
Nect306	F	10	oak-Red	church rear
Nect305	F	12	pine-scrub	
Nect303	F	12	pine-scrub	dead
Nect302	F	18	oak-Red	church front
Nect301	F	12	pine-scrub	above Tazewell
Nect117.5	F	3	myrtle	
Nect117.4	F	3	myrtle	
Nect117.3	F	3	myrtle	
Nect117.2	F	3	myrtle	
Nect117.1	F	3	myrtle	alongside church
Nect115	F	30	maple	above alley
Nect112	F	36	maple	
Nect102.4	F	2	myrtle	parking lot
Nect102.3	F	2	myrtle	parking lot
Nect102.2	F	2	myrtle	parking lot
Nect102.1	F	2	myrtle	parking lot
Nect101.4	F	2	myrtle	church
Nect101.3	F	2	myrtle	church

Street	FSR	Dia	Tree	Com 1
Nect101.2	F	2	myrtle	church
Nect101.1	F	2	myrtle	church
Nect017.3	F	14	maple	@Randolph
Nect017.2	F	30	pineLL	
Nect017.1	F	30	pineLL	
Nect016.3	F	8	maple	
Nect016.2	F	12	myrtle	
Nect016.1	F	12	myrtle	clump
Nect015	F	3	pear	
Nect013	F	3	pear	
Monro710.2	S	8	hackberry	
Monro710.1	F	10	hackberry	
Monro708.7	R	16	oak	
Monro708.6	R	8	pecan	
Monro708	R	12	holly	
Monro705.8	F	14	pineLL	
Monro705.7	F	14	pineLL	
Monro705.6	F	18	pineLL	
Monro705.5	F	14	pineLL	
Monro705.4	F	14	pineLL	
Monro705.3	F	8	maple	
Monro705.3	F	10	maple	
Monro705.2	S	8	holly	
Monro705.1	F	4	holly	
Monro704.20	S	10	pineLL	
Monro704.19	S	12	pineLL	
Monro704.18	S	12	pineLL	
Monro704.17	S	8	pineLL	
Monro704.16	S	12	pineLL	
Monro704.15	S	10	pineLL	
Monro704.14	S	12	pineLL	
Monro704.13	S	20	pineLL	
Monro704.12	S	12	pineLL	
Monro704.12	S	12	pineLL	
Monro704.11	S	14	pineLL	
Monro704.10	S	12	pineLL	
Monro704.09	F	10	pineLL	
Monro704.08	F	12	pineLL	
Monro704.07	F	12	pineLL	
Monro704.06	F	14	pineLL	
Monro704.05	F	4	myrtle	
Monro704.04	F	8	pineLL	
Monro704.03	F	12	pineLL	
Monro704.02	F	12	pineLL	
Monro704.01	F	12	pineLL	@704 Monro
Monro703.5	R	20	pineLL	
Monro703.4	R	20	pineLL	
Monro703.3	S	14	pineLL	
Monro703.2	F	12	oak-Red	
Monro703.1	F	14	fir	
Monro702.3	F	4	dogwood	
Monro702.2	F	16	myrtle	
Monro702.1	F	12	myrtle	@792 Monro
Monro700.5	F	6	dogwood	
Monro700.4	F	10	dogwood	

Street	FSR	Dia	Tree	Com 1
Monro700.3	F	8	myrtle	clump
Monro700.2	F	4	dogwood	
Monro700.1	F	6	myrtle	@Fig
Monro653	F	14	car cotton	@653 Monro
Monro648.3	M	12	myrtle	
Monro648.2	F	3	myrtle	@648 Monro
Monro648.1	M	16	myrtle	opp 648 Monro
Monro644.7	F	16	myrtle	
Monro644.6	M	12	myrtle	
Monro644.5	M	12	myrtle	
Monro644.4	M	16	myrtle	
Monro644.3	S	36	myrtle	
Monro644.2	F	12	myrtle	
Monro644.1	F	8	myrtle	@644 monro
Monro641.2	M	16	myrtle	
Monro641.1	M	12	myrtle	opp 641 Monro
Monro639.3	M	16	myrtle	
Monro639.1	F	28	car cotton	@639 Monro
Monro639.1	M	14	myrtle	
Monro635	F	24	car cotton	Sullivan
Monro632.3	R	8	fir	
Monro632.2	R	30	pecan	
Monro632.1	F	6	cherry	
Monro627.2	S	8	myrtle	
Monro627.1	F	32	myrtle	
Monro623.2	R	16	maple	
Monro623.1	F	12	cedar	@623 Monro
Monro619.5	S	20	maple	
Monro619.4	S	40	maple	
Monro619.3	S	12	spruce	
Monro619.2	F	6	fir	
Monro619.1	S	8	cherry	@619?.Monro
Monro618.2	F	20	myrtle	@618 Monro
Monro618.2	R	18	pineLL	
Monro618.1	F	20	myrtle	@618 Monro
Monro618.1	R	18	pineLL	
Monro616.3	R	28	magnolia	
Monro616.2	F	8	myrtle	
Monro616.1	F	12	myrtle	@616 Monro
Monro615.2	F	8	cottonwood	
Monro615.1	F	10	pineLL	@615 Monro
Monro609.2	F	30	maple	
Monro609.1	F	30	maple	
Monro606	F	20	"elm, dying"	@606 Monro
Monro601.2	F	4	myrtle	4 side cuts
Monro601.1	F	30	maple	@601?.Monro
Monro555	M	8	hackberry	opp 555 Monro
Monro552.3	F	32	maple	@552 Monro
Monro552.2	M	10	myrtle	
Monro552.1	F	3	oak	@552 Monro
Monro551.3	M	8	myrtle	
Monro551.2	M	8	cherry	
Monro551.1	M	14	myrtle	clump
Monro549.2	F	8	myrtle	
Monro549.1	F	30	myrtle	@549 Monro

Street	FSR	Dia	Tree	Com 1
Monro548.4	F	2	myrtle	
Monro548.3	F	2	myrtle	
Monro548.2	F	2	myrtle	
Monro548.1	F	2	myrtle	@548 Monro
Monro545	F	8	myrtle	@545 Monro
Monro542.4	F	2	myrtle	HitchingPost
Monro542.3	F	2	myrtle	@542 Monro
Monro542.2	F	2	myrtle	clump
Monro542.1	F	36	myrtle	clump
Monro539.4	M	8	myrtle	
Monro539.3	F	14	myrtle	
Monro539.2	F	30	car cotton	@539 Monro
Monro539.1	M	16	myrtle	clump
Monro538	M	18	myrtle	clump
Monro527	M	14	myrtle	clump
Monro522.4	M	8	myrtle	
Monro522.3	F	10	birch	@522 Monro
Monro522.2	F	8	myrtle	
Monro522.1	M	30	myrtle	clump
Monro518.3	F	8	myrtle	@518?.Monro
Monro518.2	F	6	myrtle	
Monro518.1	M	8	myrtle	
Monro514.3	F	24	myrtle	@514 Monro
Monro514.2	M	12	myrtle	
Monro514.1	F	6	myrtle	clump
Monro512.5	F	16	cedar	
Monro512.4	F	8	myrtle	@512 Monro
Monro512.3	M	12	hackberry	Median strip
Monro512.2	F	18	myrtle	
Monro512.1	M	8	myrtle	
Monro511.1	M	6	myrtle	
Monro509.2	F	14	car cotton	
Monro509.1	F	18	car cotton	
Monro508.2	F	72	linden	
Monro508.1	F	14	myrtle	@508?.Monro
Monro507.6	M	8	myrtle	
Monro507.5	M	8	myrtle	
Monro507.4	F	8	oak	HitchingPost
Monro507.3	F	10	myrtle	@507?.Monro
Monro507.2	M	8	plum	Median strip
Monro507.1	M	8	myrtle	
Monro506.2	F	18	myrtle	
Monro506.1	F	3	myrtle	@506 Monro
Monro505	F	8	oak	502.3
Monro504	F	6	myrtle	@505 Monro
Monro501.3	F	8	magnolia	
Monro501.2	F	8	myrtle	clump
Monro501.1	R	18	pineLL	@501 Monro
Monro240.2	F	40	myrtle	@240 Monroe
Monro240.1	M	3	myrtle	
Monro239	F	2	dogwood	@Strawberry
Monro230.4	F	4	myrtle	
Monro230.3	M	3	myrtle	
Monro230.2	F	14	magnolia	@230?.Monroe
Monro230.2	M	10	myrtle	

Street	FSR	Dia	Tree	Com 1
Monro224.2	M	8	myrtle	
Monro224.1	F	20	maple	@224 Monroe
Monro223.2	F	36	sycamore	
Monro223.1	F	6	dogwood	
Monro221.4	M	8	myrtle	
Monro221.3	F	16	sycamore	
Monro221.2	F	18	sycamore	@221 Monroe
Monro221.1	M	10	myrtle	
Monro220	F	12	holly	@220 Monroe
Monro218.1	M	8	myrtle	
Monro215.8	F	16	maple	
Monro215.7	M	10	myrtle	
Monro215.6	F	36	pecan	
Monro215.5	F	8	pecan	
Monro215.4	M	8	myrtle	
Monro215.3	F	24	oak	@215 Monroe
Monro215.2	M	8	myrtle	
Monro215.1	F	16	oak	
Monro213.3	F	12	fir	@213 Monroe
Monro213.2	M	16	myrtle	
Monro213.1	F	30	linden	
Monro212.3	S	24	myrtle	
Monro212.2	M	10	myrtle	
Monro212.1	F	30	linden	@212 Monroe
Monro208.2	M	8	myrtle	
Monro208.1	M	3	myrtle	
Monro206.6	F	8	maple	
Monro206.5	S	12	maple	
Monro206.4	F	6	maple	@206 Monroe
Monro206.3	S	12	myrtle	
Monro206.2	S	3	myrtle	
Monro206.1	F	4	myrtle	
Monro205.2	M	6	myrtle	
Monro205.1	M	12	myrtle	opp 205 Monroe
Monro204	F	8	maple	nr Pump Sta
Monro203.2	M	4	myrtle	
Monro203.1	M	10	myrtle	opp 203 Monroe
Monro201.3	M	8	myrtle	
Monro201.2	F	28	sycamore	@201 Monroe
Monro201.1	M	10	myrtle	201.2
Monro110.5	M	4	myrtle	@Pine
Monro110.4	F	14	myrtle	
Monro110.3	M	3	myrtle	
Monro110.2	F	20	myrtle	@110 Mnroe
Monro110.1	M	16	myrtle	
Monro109.3	F	3	oak	
Monro109.2	M	6	myrtle	
Monro109.1	F	3	oak	@109 Monroe
Monro106.2	M	6	myrtle	
Monro106.1	M	4	myrtle	opp 106 Monroe
Monro104	M	4	myrtle	
Monro102.4	F	14	myrtle	
Monro102.3	M	4	myrtle	
Monro102.2	M	3	myrtle	
Monro102.1	F	14	myrtle	@102 Monroe

Street	FSR	Dia	Tree	Com 1
Monro011.3	S	8	myrtle	@Harbor
Monro011.2	M	6	myrtle	
Monro011.1	F	8	myrtle	
Monro010.4	F	8	myrtle	
Monro010.3	F	8	myrtle	
Monro010.2	F	8	myrtle	
Monro010.1	F	6	fir	
Monro009.4	F	10	myrtle	
Monro009.3	M	2	myrtle	
Monro009.2	M	4	myrtle	
Monro009.1	F	4	linden	
Monro008.2	F	16	pecan	
Monro008.1	F	6	dogwood	
Monro005.9	F	30	linden	
Monro005.8	S	4	birch	
Monro005.7	M	8	myrtle	
Monro005.6	F	10	myrtle	
Monro005.5	F	12	pecan	
Monro005.4	F	6	linden	
Monro005.3	F	10	pecan	
Monro005.2	M	8	myrtle	
Monro005.1	F	6	linden	@005 Monroe
Monro002.9	F	10	cedar	@002 Monroe
Monro001.8	F	14	pecan	
Monro001.7	M	4	myrtle	guy wire
Monro001.6	F	12	myrtle	
Monro001.5	F	14	myrtle	@001 Monroe
Monro001.4	F	12	myrtle	
Monro001.3	F	10	myrtle	
Monro001.2	F	30	linden	@001 Monroe
Monro001.1	F	14	ash	
Monro000.8	F	10	ash	
Monro000.7	M	4	myrtle	
Monro000.6	F	14	pecan	
Monro000.5	F	4	oak	
Monro000.4	F	12	pecan	
Monro000.3	M	3	myrtle	
Monro000.2	F	2	maple	
Monro000.1	F	2	maple	
Mason647	R	12	maple	Ivy Threat
Mason645	F	8	myrtle	clump
Mason639	F	24	maple	
Mason638	F	14	maple	
Mason637	R	12	maple	Ivy Threat
Mason635	R	12	cherry	Ivy Threat
Mason635	R	12	cherry	Ivy Threat
Mason635	R	12	cherry	Ivy Threat
Mason635	R	12	cherry	Ivy Threat
Mason635	R	12	cherry	Ivy Threat
Mason635	R	12	cherry	Ivy Threat
Mason635	R	12	cherry	Ivy Threat
Mason635	R	12	cherry	Ivy Threat
Mason635	R	12	cherry	Ivy Threat
Mason635	R	12	cherry	Ivy Threat
Mason635	R	12	cherry	Ivy Threat
Mason549	F	14	myrtle	

Street	FSR	Dia	Tree	Com 1
Mason317	F	8	myrtle	
Mason315	F	8	myrtle	
Mason312	F	10	oak-Pin	
Mason310	F	8	oak-Pin	
Mason310	F	10	oak-Pin	
Mason309	F	14	oak-Pin	Baileys
Mason308	F	8	oak-Pin	
Mason307	F	14	oak-Red	
Mason302	F	14	myrtle	
Mason301	F	8	myrtle	@Strawberry
Mason246	F	8	myrtle	
Mason246	F	12	myrtle	
Mason246	F	8	oak-Pin	
Mason245	F	12	myrtle	
Mason245	S	42	myrtle	clump
Mason237	F	12	oak-Pin	
Mason237	F	12	oak-Red	
Mason235	F	14	oak-Pin	
Mason233	F	12	oak-Red	
Mason233	F	12	oak-Red	
Mason225	F	20	oak-Red	
Mason215	F	10	oak-Pin	
Mason207	F	12	oak-Red	
Mason201	F	3	cherry	@RR street
Mason122	F	8	oak-Red	
Mason121	F	24	myrtle	clump
Mason119	F	8	oak-Red	@Pine
Mason117	F	8	myrtle	Banks Chir
Mason111	F	8	oak-Red	
Mason109	F	10	cherry	Sullivans
Mason101	F	12	oak-Pin	@Harbor
Mason015	S	12	magnolia	
Mason013	S	24	maple	
Mason011	F	18	plum	Sullivans
Mason009	F	18	ash	
Mason007	F	8	myrtle	
Mason007	F	10	myrtle	
Mason006	F	36	sycamore	clump 5
Mason005	S	8	cedar	
Mason005	F	6	myrtle	
Mason005	F	8	myrtle	
Mason004	F	36	sycamore	clump 8
Mason003	F	6	myrtle	
Mason002	F	8	myrtle	
Mason001	F	30	cherry	
Madisn650..4	F	10	myrtle	@Fig
Madisn650..3	F	16	myrtle	
Madisn650..2	F	8	myrtle	@650?.Madisn
Madisn650..1	F	18	myrtle	
Madisn641.4	F	6	myrtle	
Madisn641.3	F	14	myrtle	
Madisn641.2	F	6	myrtle	
Madisn641.1	F	6	cherry	Parking Lot
Madisn639.2	S	18	maple	
Madisn639.1	S	18	maple	

Street	FSR	Dia	Tree	Com 1
Madisn637	F	8	car cotton	
Madisn636.2	F	6	cherry	
Madisn636.1	F	6	cherry	@636 Madisn
Madisn635	F	8	car cotton	
Madisn635	F	14	car cotton	
Madisn633	F	18	car cotton	
Madisn631	F	18	car cotton	
Madisn629	F	16	car cotton	
Madisn627	F	30	car cotton	@627 Madisn
Madisn625.2	F	14	myrtle	trimmed
Madisn625.1	F	14	myrtle	@625 Madisn
Madisn606.2	F	8	myrtle	
Madisn606.1	F	14	myrtle	@606 Madisn
Madisn603	F	6	myrtle	
Madisn602	F	8	myrtle	@602 Madisn
Madisn601	F	14	maple	
Madisn555	F	4	myrtle	@Nectarine
Madisn548	S	24	pecan	
Madisn542.3	S	24	maple	
Madisn542.2	S	24	maple	
Madisn542.1	S	24	maple	
Madisn513.2	F	16	oak	
Madisn513.1	F	18	oak	@513 Monro
Madisn502	F	18	maple	lot
Madisn501.3	F	20	maple	
Madisn501.2	F	18	maple	
Madisn501.1	F	20	maple	
Madisn500.3	F	10	myrtle	
Madisn500.2	F	24	myrtle	clump
Madisn500.1	F	8	magnolia	
Madisn420	F	12	cherry	@Plum
Madisn319	F	28	maple	
Madisn316	F	8	hackberry	@Peach
Madisn312	F	10	pecan	
Madisn303.4	S	16	maple	
Madisn303.3	S	6	maple	
Madisn303.2	S	8	maple	@303 Monro
Madisn303.1	F	14	maple	
Madisn302	F	8	cottonwood	
Madisn301	F	18	maple	@Church
Madisn300	F	10	pineLL	
Madisn225	F	20	car cotton	@225 Madisn
Madisn224	F	20	maple	@Strawberry
Madisn222.2	R	36	maple	
Madisn222.1	F	20	maple	
Madisn220.2	R	24	maple	
Madisn220.1	F	22	maple	@220 Madisn
Madisn219	F	10	hickory	
Madisn218	F	8	myrtle	@218 Madisn
Madisn217.4	R	36	walnut	
Madisn217.3	R	24	walnut	
Madisn217.2	F	36	car cotton	
Madisn217.1	F	40	car cotton	@217 Madisn
Madisn217	F	10	linden	
Madisn212.2	F	14	corkscrew	

Street	FSR	Dia	Tree	Com 1
Madisn212.1	F	8	holly	212 Madisn
Madisn211.2	S	24	pecan	
Madisn211.1	F	16	maple	
Madisn209.3	F	8	myrtle	clump 5
Madisn209.2	F	8	myrtle	@209 Madisn
Madisn209.1	F	8	myrtle	clump 5
Madisn208	F	10	holly	@208 Madisn
Madisn205.2	R	12	pecan	
Madisn205.1	R	12	pecan	
Madisn204	F	30	oak-Pin	@204 Madisn
Madisn202	F	10	birch	@202 Madisn
Madisn200.2	F	8	myrtle	bunchy
Madisn200.1	F	12	myrtle	
Madisn105.2	F	20	car cotton	
Madisn105.1	F	4	myrtle	@105 Madisn
Madisn104	F	8	oak	@104 Madisn
Madisn101.3	S	16	cedar	
Madisn101.2	F	16	myrtle	@101 Madisn
Madisn101.1	F	20	car cotton	
Madisn100.2	F	30	myrtle	@100 Madisn
Madisn100.1	F	14	myrtle	@Harbor
Madisn010.2	F	16	pecan	
Madisn010.1	F	24	pecan	@010?.Madisn
Madisn003.5	F	24	magnolia	@Harbor
Madisn003.4	F	32	maple	@003 Madisn
Madisn003.3	R	12	holly	
Madisn003.2	S	14	magnolia	
Madisn003.1	F	14	pineLL	
Madisn002.5	S	40	maple	
Madisn002.4	F	10	myrtle	
Madisn002.3	F	12	pecan	
Madisn002.2	F	12	pineLL	@002 Madisn
Madisn002.1	F	12	pineLL	@Bay Ave
Madisn001.4	S	24	pecan	
Madisn001.4	F	18	sycamore	
Madisn001.3	F	24	pecan	
Madisn001.2	F	20	pecan	@001 Madisn
Madisn001.2	F	16	sycamore	
Jeffer637	S	24	hackberry	@Fig
Jeffer635	F	14	hackberry	
Jeffer632	F	6	myrtle	
Jeffer620.2	F	14	maple	
Jeffer620.1	F	30	hackberry	
Jeffer615	F	14	myrtle	clump
Jeffer613	F	28	magnolia	@613 Jeffer
Jeffer606.2	S	24	willow	
Jeffer606.1	S	24	willow	
Jeffer601	F	30	hackberry	@601 Jeffer
Jeffer539.3	F	6	myrtle	@Nectarine
Jeffer539.2	F	4	myrtle	@539 Jeffer
Jeffer539.1	F	3	myrtle	
Jeffer534	F	10	hackberry	
Jeffer527.2	F	12	myrtle	
Jeffer527.1	F	14	myrtle	
Jeffer410	F	14	mulberry	@Plum

Street	FSR	Dia	Tree	Com 1
Jeffer302	F	12	oak	@Strawberry
Jeffer240.3	F	12	pineSL	8 pines in rear
Jeffer240.2	F	10	pineSL	@240?.Jeffer
Jeffer240.1	F	4	pear	
Jeffer226	F	12	pineLL	@226 Jeffer
Jeffer225.3	F	8	myrtle	
Jeffer225.2	F	30	cedar	@225 Jeffer
Jeffer225.1	F	18	myrtle	
Jeffer224.3	F	8	myrtle	
Jeffer224.2	F	6	fir	@224?.Jeffer
Jeffer224.1	F	6	myrtle	
Jeffer222.2	F	3	myrtle	
Jeffer222.1	F	40	maple	@222 Jeffer
Jeffer219	F	12	myrtle	clump
Jeffer218	F	6	myrtle	@218 Jeffer
Jeffer217.2	F	6	myrtle	
Jeffer217.1	F	4	myrtle	@217 Jeffer
Jeffer214.2	F	3	myrtle	
Jeffer214.1	F	3	myrtle	
Jeffer211.2	F	20	oak	
Jeffer211.1	F	24	oak	@211 Jeffer
Jeffer209	F	4	dogwood	@209 Jeffer
Jeffer206.2	F	3	myrtle	clump
Jeffer206.1	F	3	myrtle	clump
Jeffer103.2	F	3	myrtle	
Jeffer103.2	F	3	myrtle	
Jeffer103.1	F	3	myrtle	
Jeffer100.4	F	14	myrtle	@Pine
Jeffer100.3	F	6	pineLL	
Jeffer100.2	F	4	pineLL	
Jeffer100.1	F	12	myrtle	
Jeffer002.4	F	14	maple	clump; @Harbor
Jeffer002.3	F	8	maple	
Jeffer002.2	F	8	myrtle	beside 511 Harbor
Jeffer002.1	F	14	myrtle	clump
Jeffer000.2	F	14	"elm, american"	
Jeffer000.1	F	12	"elm, american"	@Bay
Harbr511.2	F	6	myrtle	@Jeffers
Harbr511.1	F	12	myrtle	
Harbr507	F	12	myrtle	
Harbr506.2	F	12	myrtle	
Harbr506.1	F	12	myrtle	@506 Harbr
Harbr505.2	F	6	myrtle	
Harbr505.1	F	10	pecan	@505 Harbr
Harbr500.3	F	12	pecan	@Blue Hse
Harbr500.2	F	8	pecan	@Blue Hse
Harbr500.1	F	10	pecan	@Blue Hse
Harbr410.3	F	10	myrtle	@Madison
Harbr410.2	F	10	myrtle	clump
Harbr410.1	F	14	myrtle	clump
Harbr407.2	F	10	myrtle	
Harbr407.1	F	6	myrtle	@407 Monro
Harbr401.2	F	4	myrtle	
Harbr401.1	F	6	myrtle	
Harbr309.3	F	8	myrtle	

Street	FSR	Dia	Tree	Com 1
Harbr309.2	F	12	myrtle	
Harbr309.1	F	6	myrtle	side of 102 Monro
Harbr308.3	F	8	myrtle	@Monroe
Harbr308.2	F	8	myrtle	
Harbr308.1	F	8	myrtle	
Harbr304.2	F	12	myrtle	
Harbr304.1	F	6	myrtle	@3 Tazewell
Harbr301.5	F	8	myrtle	
Harbr301.4	F	3	myrtle	
Harbr301.3	F	4	myrtle	
Harbr301.2	F	6	myrtle	
Harbr301.1	F	3	myrtle	side of 9 Tazewell
Harbr300.4	F	4	myrtle	
Harbr300.3	F	3	myrtle	
Harbr300.2	F	4	myrtle	
Harbr300.1	F	3	myrtle	side of 101 Tazewell
Harbr214.4	F	10	myrtle	
Harbr214.3	F	10	myrtle	
Harbr214.2	F	10	myrtle	
Harbr214.1	F	6	myrtle	
Harbr210.5	F	6	myrtle	
Harbr210.4	F	6	myrtle	
Harbr210.3	F	6	myrtle	
Harbr210.2	F	6	myrtle	
Harbr210.1	F	3	myrtle	@210 Harbr
Harbr206.2	F	14	myrtle	clump@pole
Harbr206.1	F	16	oak	@206 Harbr
Harbr202	F	8	maple	
Harbr201.5	F	60	linden	Dead? Danger!
Harbr201.4	F	6	oak	
Harbr201.3	F	4	pine-Scrub	
Harbr201.2	F	8	oak	
Harbr201.1	F	18	linden	side of 11 Rand
Harbr015	F	14	oak	@Randolph
Harbr014	F	12	myrtle	@alley
Harbr005.9	F	8	hackberry	
Harbr005.8	F	6	myrtle	
Harbr005.7	F	6	hackberry	
Harbr005.6	F	10	myrtle	
Harbr005.5	F	14	hackberry	
Harbr005.4	F	10	myrtle	
Harbr005.3	S	12	myrtle	
Harbr005.2	S	14	myrtle	clump
Harbr005.11	F	12	hackberry	@Randolph
Harbr005.10	F	12	myrtle	
Harbr005.1	F	10	myrtle	clump
Harbr001.3	F	8	myrtle	
Harbr001.2	F	10	myrtle	
Harbr001.1	F	28	linden	
Fulch300.8	F	3	oak	to Monroe Ave
Fulch300.7	F	3	pineLL	
Fulch300.6	F	3	pineLL	
Fulch300.5	F	3	oak	
Fulch300.4	F	3	pineLL	
Fulch300.3	F	3	pineLL	

Street	FSR	Dia	Tree	Com 1
Fulch300.2	F	3	oak	
Fulch300.1	F	3	pineLL	opp 300 Fulcher
Fulch109.15	S	12	cedar	
Fulch109.14	S	10	cedar	
Fulch109.13	S	6	cedar	
Fulch109.12	S	12	cedar	
Fulch109.11	S	8	cedar	
Fulch109.10	S	10	cedar	
Fulch109.09	S	8	cedar	
Fulch109.08	S	12	cedar	
Fulch109.07	S	4	cedar	
Fulch109.06	S	8	cedar	
Fulch109.05	S	8	cedar	
Fulch109.04	S	6	cedar	
Fulch109.03	S	6	cedar	
Fulch109.02	S	12	cedar	
Fulch109.01	F	8	cedar	
Fulch108.3	F	3	pineLL	
Fulch108.2	F	3	oak	
Fulch108.1	F	3	pineLL	
Fulch106.6	F	3	pineLL	
Fulch106.5	F	3	oak	
Fulch106.4	F	3	pineLL	
Fulch106.3	F	3	pineLL	
Fulch106.2	F	3	oak	
Fulch106.1	F	3	pineLL	@pole
Fulch104.9	F	3	pineLL	@Tazewell
Fulch104.8	F	3	oak	
Fulch104.7	F	3	pineLL	
Fulch104.6	F	3	pineLL	
Fulch104.5	F	3	pineLL	
Fulch104.4	F	3	oak	
Fulch104.3	F	3	pineLL	
Fulch104.2	F	3	pineLL	
Fulch104.1	F	3	oak	
Fulch102.6	F	3	pineLL	driveway
Fulch102.5	F	3	pineLL	
Fulch102.4	F	3	oak	
Fulch102.3	F	3	pineLL	
Fulch102.2	F	3	oak	
Fulch102.1	F	3	pineLL	above Randolph
Fig680	F	3	oak	@Jefferson
Fig678	F	3	oak	
Fig676	F	3	oak	
Fig674	F	3	oak	
Fig672	F	3	oak	
Fig670	F	3	oak	
Fig668	F	3	oak	
Fig666	F	3	oak	
Fig664	F	3	oak	
Fig662	F	3	oak	
Fig660	F	3	oak	
Fig658	F	3	oak	
Fig565	F	3	oak	
Fig548	F	3	oak	

Street	FSR	Dia	Tree	Com 1
Fig546	F	3	oak	
Fig544	F	3	oak	
Fig542	F	3	oak	
Fig540	F	3	oak	
Fig518	F	3	oak	
Fig516.2	R	20	pineLL	
Fig516.1	F	3	oak	
Fig514.2	R	12	pineLL	
Fig514.1	F	3	oak	
Fig512.2	R	12	pineLL	
Fig512.1	F	3	oak	
Fig510.2	F	36	locust	@Madison
Fig510.1	R	20	pineLL	
Fig510	F	3	oak	
Fig508	S	18	pineLL	
Fig506	R	20	pineLL	
Fig504	R	18	pineLL	
Fig502	R	20	pineLL	
Fig490	F	36	linden	Ivy Threat
Fig480.6	F	6	myrtle	Bottle Co
Fig480.5	F	6	myrtle	Bottle Co
Fig480.4	F	6	myrtle	Bottle Co
Fig480.3	F	6	myrtle	Bottle Co
Fig480.2	F	6	myrtle	Bottle Co
Fig480.1	F	6	myrtle	Bottle Co
Fig470	F	40	linden	
Fig438.2	F	40	linden	@Monroe
Fig438.1	F	36	linden	
Fig437	F	16	linden	Ivy Threat
Fig409.2	F	8	dogwood	
Fig409.1	F	8	dogwood	
Fig304	F	24	sycamore	
Fig304	F	36	sycamore	Ivy Threat
Fig303	F	16	hackberry	
Fig302.6	F	24	sycamore	
Fig302.5	F	24	sycamore	
Fig302.4	F	24	sycamore	
Fig302.3	F	24	sycamore	
Fig302.2	F	24	sycamore	
Fig302.1	F	24	sycamore	
Fig301	F	14	myrtle	
Fig118	F	24	fir	
Fig116	F	36	maple	
Fig114.3	S	30	pineLL	
Fig114.2	S	24	pineLL	
Fig114.1	F	8	fir	
Fig112.6	S	8	pineLL	
Fig112.5	S	8	pineLL	
Fig112.4	S	8	pineLL	
Fig112.3	S	8	pineLL	
Fig112.2	S	8	pineLL	
Fig112.1	S	8	pineLL	
Fig109	F	24	maple	
Fig101	F	4	myrtle	
Fig002.4	F	3	myrtle	Rayfields

Street	FSR	Dia	Tree	Com 1
Fig002.3	F	3	myrtle	Rayfields
Fig002.2	F	3	myrtle	Rayfields
Fig002.1	F	3	myrtle	Rayfields
Bay408	F	14	elm	
Bay406	S	24	mulberry	
Bay402.2	F	12	poplar	
Bay402.1	F	12	poplar	
Bay400.4	F	36	maple	
Bay400.3	F	30	maple	
Bay400.2	F	24	maple	
Bay400.1	F	10	poplar	
Bay306.4	F	36	maple	
Bay306.3	F	36	maple	
Bay306.2	F	36	maple	
Bay306.1	F	30	maple	
Bay304	F	36	maple	
Bay302	F	30	maple	
Bay216	S	30	locust	
Bay214	F	6	cedar	
Bay212	F	6	cedar	
Bay210	F	6	cedar	
Bay106	F	20	magnolia	
Bay104.2	F	16	pecan	
Bay104.1	F	12	pecan	
Bay102.2	F	6	poplar	
Bay102.1	F	6	poplar	
Bay100.2	F	10	pineSL	
Bay100.1	F	10	pineSL	

